



BREWSTER  PLACE

HOME FINDER

Call 785-274-3351



www.BrewsterLiving.org

We are thrilled to present you with an exciting selection of newly listed Independent Living homes and apartments available at Brewster Place in Topeka, Kansas! Whether you want to downsize into a one-bedroom apartment, or if you prefer a cozy cottage or even a grand home, we have something for everyone. Read on to find your dream living space at Brewster Place!

GRAND HOME 2937

3 Bedrooms + 3 Bath

For those of you who value spaciousness and grandeur, our grand home will exceed your expectations! Number 2937 has 2,352 square feet of living space on the main level and 1,868 square feet of finished living space on the lower level. With an attached 2 car garage, this home provides ample room for you to live and entertain. Additionally, the fenced-in yard offers the perfect space to relax and enjoy the outdoors.





The focal point of this spacious living room is a gas-burning fireplace with a traditional style mantle, chandelier lighting, bay windows, and gorgeous hardwood floors.



This home has a French country feel with beautiful cabinetry in a full chef's kitchen featuring unique elements and appliances such as a jar opener, custom cutting boards, and a walk-in pantry.



Storage galore! The rooms are not only generous in size, but also include walk-in closets. There is also an unfinished storage room in the basement.

BIRCHWOOD COTTAGE 3

2 Bedrooms + 2.5 Bath

Embrace the joys of independent living surrounded by our picturesque courtyard, only steps away from the Market Pavillion, with 1200 sq ft on the main level and 800 sq ft in the basement.

A perfect choice for those who value privacy, this beautiful and charming cottage offers a recently upgraded Chef's kitchen, spacious living areas, and a private enclosed patio for you to enjoy fresh air.



NORTH TERRACE 24

2 Bedroom + 1 Bath



Enjoy the wonderful community atmosphere at Brewster Place at an affordable price point. This cozy, 600 sq. ft, two-bedroom, one bath residence is located on the upper floor of the inviting Terrace Apartments that situate as bookends to the Aspen Cottages. Walk outdoors from your front door and enjoy the view of the beautiful pollinator garden. An efficient kitchen nook includes a full-size refrigerator with ice maker, sink, garbage disposal, microwave, and oven. Be creative with opportunities to upgrade your space!

1 Bedroom + 1 Bath

SOUTH TERRACE 27

"Hello, Sunshine!" is what you'll say when you walk through the door of this completely renovated one bedroom/one bath South Terrace apartment. Features 500 sq ft of living space, light and bright with wood luxury vinyl plank flooring throughout, white six panel doors, and a cheery kitchen with light yellow cabinets and white appliances including refrigerator with ice maker, electric range, microwave, and dishwasher!



Join **BREWSTERCONNECT**



- ✓ **FITNESS & ART CLASSES**
- ✓ **INDOOR POOL**
- ✓ **FINE DINING**
- ✓ **OSHER SERIES**
- ✓ **SOCIALS**
- ✓ **PICKLEBALL**
- ✓ **EVENTS**
- ✓ **DAY TRIPS, & MORE!**

MONTHLY MEMBERSHIP

\$55

BREWSTER  PLACE

MONTHLY FEE PER ACTIVE ADULT AGE 55+

CALL 785-274-3305

WWW.BREWSTERLIVING.ORG/BREWSTERCONNECT

Now Offering Respite Care

Limited Time

For individuals needing support in Assisted Living for up to 60 days as they transition from a medical facility.

FEATURES: 24 Hour Assistance/Security, Memory Support, Furnished Apartments, Basic cable, TV, WIFI, Phone, 3 cooked meals daily with snacks, Housekeeping, Laundry, Nursing Services, Enrichment Activities & more!



STUDIO PER DAY: \$200 | 1 BDRM APARTMENT PER DAY: \$275

Call 785-274-3385

www.brewsterliving.org

BREWSTER  PLACE



Relax and leave the cooking, cleaning, and laundry to us!

Live it up in the center of it all!

The Redwood is undergoing an extraordinary transformation, with 23 brand new apartments and the addition of a 6th floor featuring penthouse suites. A perfect place to call Home, Redwood also offers studios and one-bedroom apartments that provide the perfect blend of comfort and functionality.

Catered living includes all 3 cooked meals daily, utilities, phone, standard cable service, Wifi, bi-weekly housekeeping and laundry, covered parking, emergency life alarm pendant, 24-hour security, priority use of health services, on campus transportation, activities and events, indoor pool, library, Main St Market Pavilion with Chapel, salon & spa, bank, and more.



PENTHOUSE SUITES

2 Bedrooms + 2 Bath, 1436-1782 sq. ft

Reserve your Suite Spot at the Top!

A penthouse lifestyle includes your suite complete with walk-in closets, floor-to-ceiling windows, large balconies, gaslight fireplaces and expansive, campus views! These sophisticated spaces have been thoughtfully designed to ensure the utmost comfort and style. **Only 3 are left; 2 Facing East, 1 Facing West. Available in the spring of 2024.**

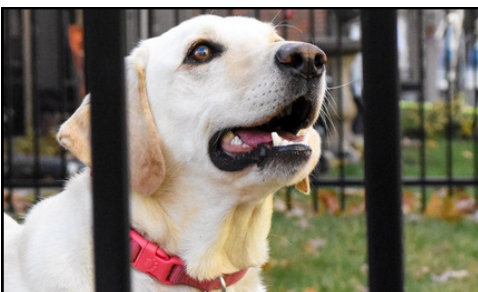
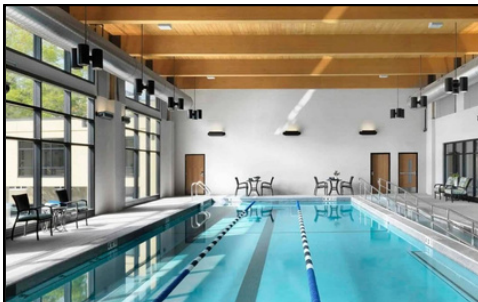

THE NEXT MOVE IS YOURS!

Brewster Place Home Finder monthly e-mail newsletter highlights homes that are presently available at Brewster Place Retirement Community in Topeka, Ks. This is a great way for those who are interested in moving to Brewster Place to consider what appeals to them and contact our sales team to book a tour. Be sure to check out each installment as availability is constantly changing, and we offer many different styles of homes and floorplans on our 35-acre campus to best accommodate the needs and preferences of all our residents.

A tour is an excellent opportunity to witness firsthand the sense of community, care, and excellence that sets Brewster Place apart. Our team members would be delighted to show you around, answer any questions you might have, and discuss how we can meet your unique needs. Call 785-274-3351 or 785-274-3394 today!



SUBSCRIBE TO HOME FINDER